



LensLeech: On-Lens Interaction for Arbitrary Camera Devices

Christopher Getschmann
cget@cs.aau.dk
Aalborg University
Aalborg, Denmark

Florian Echterler
floech@cs.aau.dk
Aalborg University
Aalborg, Denmark

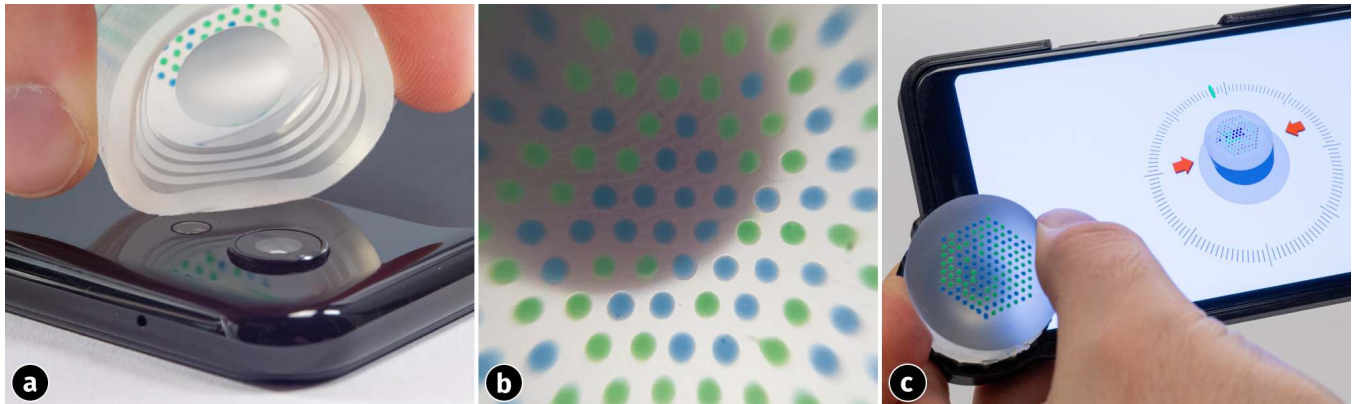

Figure 1: a) The soft silicone attachment with an integrated lens can be placed directly on or several millimeters above cameras. b) A marker point pattern is focused by the silicone lens into the camera. c) Arbitrary devices with cameras, such as a smartphone can track the position, rotation, and deformation of the silicone attachment on the camera to sense input.

ABSTRACT

Cameras provide a vast amount of information at high rates and are part of many specialized or general-purpose devices. This versatility makes them suitable for many interaction scenarios, yet they are constrained by geometry and require objects to keep a minimum distance for focusing. We present the LensLeech, a soft silicone cylinder that can be placed directly on or above lenses. The clear body itself acts as a lens to focus a marker pattern from its surface into the camera it sits on. This allows us to detect rotation, translation, and deformation-based gestures such as pressing or squeezing the soft silicone. We discuss design requirements, describe fabrication processes, and report on the limitations of such on-lens widgets. To demonstrate the versatility of LensLeeches, we built prototypes to show application examples for wearable cameras, smartphones, and interchangeable-lens cameras, extending existing devices by providing both optical input and output for new functionality.

CCS CONCEPTS

• **Human-centered computing** → **Interaction devices**; *Ubiquitous and mobile devices*; • **Hardware** → Emerging interfaces.



This work is licensed under a Creative Commons Attribution-Share Alike International 4.0 License.

TEI '24, February 11–14, 2024, Cork, Ireland
© 2024 Copyright held by the owner/author(s).
ACM ISBN 979-8-4007-0402-4/24/02.
<https://doi.org/10.1145/3623509.3633382>

KEYWORDS

Mobile Interfaces, Elastomer Sensors, Optical Widgets

ACM Reference Format:

Christopher Getschmann and Florian Echterler. 2024. LensLeech: On-Lens Interaction for Arbitrary Camera Devices. In *Eighteenth International Conference on Tangible, Embedded, and Embodied Interaction (TEI '24)*, February 11–14, 2024, Cork, Ireland. ACM, New York, NY, USA, 10 pages. <https://doi.org/10.1145/3623509.3633382>

1 INTRODUCTION

There is an increasing number of mobile devices that make use of cameras as primary or additional sensors. At the same time, physical input has become a scarce feature on modern, highly-integrated devices. Many of these camera devices are limited in their input channels and the interaction techniques they can offer due to trade-offs and design decisions to make them smaller, sleeker, more robust, or less expensive. Very small devices such as action cameras or wearables have either very few buttons or small touch screens, requiring to delegate even basic input tasks to paired smartphones or suffer from the fat finger problem [35]. Larger, interchangeable-lens cameras do provide both larger touchscreens and more buttons but could benefit from additional input options such as back-of-device interaction as well [2]. Smartphones and tablets with capacitive touchscreens offer no physical feedback, have reachability issues [46], and require visual confirmation for input [4]. While all of these devices could benefit from additional physical input, they have in common that they include a powerful sensor: a camera. Yet, any camera requires a minimal focal distance to provide focused images necessary to process rich user input [50, 51].

We present the LensLeech, a soft silicone attachment that can be placed directly on or several millimeters above the front element of camera lenses. The silicone is optically clear and deformable so forces applied by fingers, hands, or arbitrary objects can be detected visually. By using the lower surface of the silicone body itself as a close-focus lens, a marker pattern on the opposite surface is always in focus regardless of the minimum focal distance of the camera lens.

With the LensLeech we can transform an unused or idle camera lens into a physical button, a rotary knob, or a d-pad widget (and reverse it in seconds). These widgets provide physical feedback when deformed, can be operated with gloves, and are robust, versatile, and inexpensive. This allows to add knobs and d-pads to small wearable cameras to change settings in situ, use lens caps for large cameras as input devices, or introduce novel optical attachments for smartphones.

In summary, we contribute:

- a tangible deformation sensor to create buttons, knobs, and d-pads, combining soft body, optical elements, and sensing pattern in a single object
- discussions on the design and fabrication of on-lens widgets
- an image processing pipeline for analyzing position, rotation, and deformation
- application examples for integration with new and existing devices

Many research approaches aim at providing novel functionality with new or existing sensors for future devices, often built on the assumption or requirement of a possible miniaturization and integration of this external sensing hardware into a new device with a new form factor. However, we explicitly aim at retrofitting existing and well-proven interaction techniques to sensors that make them available both to legacy devices today as well as new ones in the future. This could help to extend the lifetime of devices in circulation by improving their usability and reducing incentives to update to new hardware prematurely. A user study (with regard to the input capabilities of the widgets) is not presented as these input modalities are well understood and can be directly applied to this new form factor.

The remainder of this paper is organized as follows: related work is discussed with a broad overview of vision-based elastomer sensors and on-lens/around-lens interaction techniques, then we explain our concept of soft silicone attachments for on-lens interaction sensing. The image processing pipeline and fabrication procedure are summarized subsequently. We built upon that by presenting a set of scenarios and prototypes created to show real-world applications. Finally, we discuss the practical and optical limitations of using soft silicone attachments for on-lens interaction and conclude with specific directions for future work.

2 RELATED WORK

Relevant to the presented work are both optical deformation sensors primarily developed for robotic applications as well as human-computer interaction techniques and prototypes that gather input from the space on and around camera lenses.

2.1 Optical Elastomer Sensors

Optical deformation sensing of soft materials is performed either by measuring light altered by the surface or by detecting displacement of high-contrast markers, on the surface or encapsulated in the material. Surface deformation measurements have been proposed based on total internal reflection [10], Lambertian reflection [5, 6, 14, 36, 39, 41] and polarization [29]. The most common type of sensor, the *GelSight* family, makes use of Lambertian reflection by coating the clear elastomer with a reflective membrane. Multispectral illumination from below allows to derive deformation depth and thus a detailed 2.5d geometry of the reflective surface. For marker-based sensing, high-contrast points are painted on the clear surface of the elastomer [5, 36, 39], on the interior of an opaque hull for TacTip sensors [40, 45] or colored balls are directly encapsulated in the soft material [16, 33, 52].

These sensors have been used extensively for tactile sensing in robotic applications, mounting the sensor on the end effector to measure gripping force and detect slipping. For this, the sensor assembly is designed as a monolithic unit consisting of camera sensor, lens, and elastomer block. While mirrors [6, 39] and fish-eye lenses [36] have been used to shorten optical paths to create more compact grippers these sensors are still of considerable size and rely on a tight integration of all components, making them incompatible with arbitrary cameras. Modular approaches offer only exchangeable elastomers while still using a specialized camera [19]. Additionally, all gel-based sensors with the exception of the sensor by Obinata et al. [24] and *Fingervision* [52] block environmental light and require white, RGB or ultraviolet illumination by integrated LEDs. For a detailed overview refer to the reviews by Shimonomura [34] and Abad et al. [1].

In the domain of human-computer interaction, elastomer sensors have been used for interactive surfaces [7], clay-like projection displays [27] and tangibles on tabletops [9, 43] to support novel interaction techniques.

2.2 On-Lens/Around-Lens Interaction

Placing a fingertip directly on a smartphone camera lens has been proposed as an interaction technique in *LensGestures* [50]. The unfocused environmental light passing through a finger's tissue is used to approximate finger positions and recognize gestures. *CamTrackPoint* [51] improves on this concept by providing tactile feedback. A spring-actuated plastic ring is integrated with a smartphone case directly over the lens for the finger to rest on. The thin ring blocks light with a sharp transition to black and provides a higher precision compared to tracking the blurred finger. A proof-of-concept for more complex on-lens input techniques is presented by Watanabe et al. [41]: soft and optically clear toys with a reflective surface coating are placed on the camera while a neural network is trained to recognize deformation/gestures from internal reflections observed through a hole in the bottom. This represents the simplest and most basic on-lens widget: unfocused, untagged, unpowered and depending on natural illumination, but very easy to manufacture and not obstructing the camera when not in use.

Interaction in the space around lenses requires mirrors to both shorten the optical path and redirect light. *Clipwidgets* [38] makes use of a conical mirror in a bulky smartphone case to read the state

of physical widgets such as buttons and sliders. Similar approaches have been presented for back-of-device interaction concepts with smartphones [18, 22, 47]. Without relying on physical input objects *Handsee* [54] utilizes a prism to track hands touching and floating above a smartphone display while *Surroundsee* [53] tracks objects in the whole room with a circular 360-degree mirror above the smartphone camera.

Similar techniques have been used without mirrors or lenses in the context of tangles with silicone feet for pressure sensing [43], deformation sensing on small wearables [42], and surface position sensing with fibers [44]. Other work that is related to the presented concept is *Bokode* [23], a marker made of a lenslet and microfilm which magnifies a grid of 2D barcodes into the defocused lens of a camera and *Sauron* [30], a design tool to integrate cameras in hollow objects that read the state of mechanical input elements.

However, repurposing existing sensors to create new or extend existing input channels is more common with sensors other than cameras. Adding physical widgets or additional controls to smartphones and tablets has been proposed based on accelerometers [48], magnetometers [3, 11], external hall sensors [21], microphones [20], and particularly capacitive touchscreens [8, 12, 17, 31, 49, 55]. Each approach introduces a set of issues: redirecting capacitive touch input covers a section of the display, magnetometers are imprecise and limited in their bandwidth, and microphone-based sensing requires the active generation of ultrasound by the speakers of the phone. In comparison: vision-based input blocks its sensor as well and makes use of more processing power than other types of sensors. However, many of the other sensors used for repurposing require careful per-device calibration or extensive machine-learning models to extract input from raw sensor data. To visually detect a LensLeech, only the deformation marker pattern must be known. Additionally, other sensors used for repurposing can be found most commonly in smartphones, while an optical widget is not limited to phones and can be applied across a range of devices, see the application examples in section 5.

Since earlier on-lens interaction concepts such as *CamTrackPoint* and *LensGestures* make use of unfocused light, they are limited in their expressiveness due to the low amount of information available. While they are suitable for smartphones and their scratch-resistant camera assemblies, these concepts translate poorly to interchangeable lens cameras or action cams with lens front elements often using coatings sensitive to scratches or prints from fingertips. This is one of the fundamental issues we intend to address with our generalizable approach.

3 THE DESIGN OF ON-LENS WIDGETS

We propose that any physical attachment enabling on or around-lens interaction with both existing and future devices should—ideally—adhere to these basic design considerations:

- **safe** to use with sensitive optical components and providing credible reassurance to the user about this. This is a prerequisite for user acceptance.
- **non-invasive**, requiring no hardware modifications of the host device or its camera. This ensures compatibility with existing devices that benefit most from optical attachments.

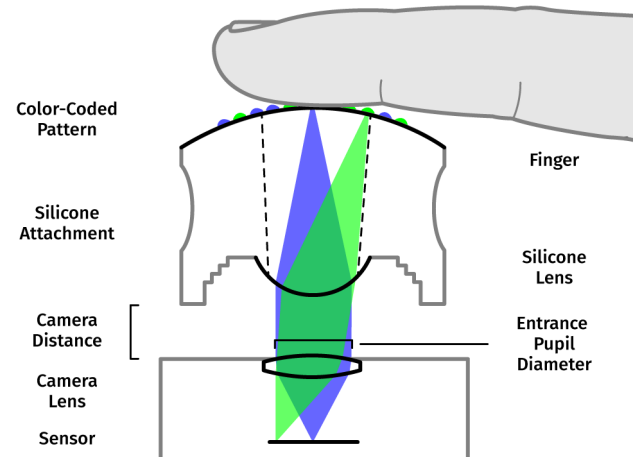

Figure 2: Illustrative ray diagram of the combined optical system. The field of view inside the silicone (dashed line) depends on the field of view of the camera, the position and diameter of the entrance pupil, as well as the distance between silicone and camera lens.

- **passive** and unpowered, requiring only ambient illumination (if possible) to reduce size and complexity.
- **universal**; compatible with arbitrary camera/lens combinations across a wide range of device types.

Elastomer sensors in general fulfill the first and most important of these requirements by virtue of their nature: they are soft. However, existing sensors fall short in most or all other points.

As discussed, these sensors combine camera and elastomer in a permanent assembly with a fixed position and rotation, limiting the possible set of gestures available for interaction to basic deformations of the elastomer. Additionally, they make use of known sensor and lens combinations to allow camera calibration and optimizations of sensor geometry (for example by backprojecting through a calibrated lens to find optimal marker point placements). This makes these sensors more precise and reliable but prevents them from being used with arbitrary lenses and cameras. Finally, most sensors require constant internal illumination. Reflective membranes (GelSight) and rubber skins (TacTip) are blocking ambient light to avoid interference. Only sensors relying solely on point patterns [24, 52] can tolerate ambient illumination.

We propose an elastomer sensor design suitable for interaction sensing. The LensLeech is a tangible soft input device that resembles the gel part of an elastomer sensor. Our all-silicone design combines a lens, compliant body, and a colored marker pattern in a single unit (see fig. 2). This addresses all design requirements at the cost of reduced reliability and precision compared to elastomer sensor assemblies that are designed to measure precise gripping forces on robot actuators.

The small size of the LensLeech attachment (33mm diameter, 25.5mm height) makes it convenient to grasp with two fingers and place it on a camera. By using the lower surface of the clear silicone body as a lens, light reflected by the deformation-sensing pattern on the surface is collimated and can be focused on the sensor at

any distance from the camera. This makes it possible to place the silicone foot of the LensLeech directly on or several millimeters above the front element of a wide range of lenses. The combined optical system of sensor, camera lens, silicone lens, and deformation sensing pattern is limited by the field of view of the camera, its entrance pupil, and the distance to the silicone attachment. These limitations are discussed in more detail in section 6.

Marker Pattern

When choosing a marker pattern for deformation sensing, we need to take into account that a positive (convex) lens required to move the focal point to the surface of the silicone body will introduce a strong magnification effect. This amplifies any defects or irregularities and requires the fabrication of very small features for the marker pattern. The most precise and reliable method at this small scale is the deposition of single droplets of silicone paint and makes a point pattern the preferred choice.

Point patterns are used by other optical tactile sensors such as TacTip and GelSight as well, however, these sensors are fixed assemblies that can compute deviations from a static reference frame. This does not apply to a silicone sensor that can be moved and rotated freely, thus a method to align the currently visible region of interest with the overall marker grid is required.

A common method for identifying sections of point grids are two-dimensional DeBruijn sequences. These are sequences that contain every subsequence of a defined size at most once. Printed as microdots on paper DeBruijn sequences have been used for position-tracking with digital pens [26] (encoding bits as a displacement from a regular grid) and tangibles [32] (encoding bits as black and white). However, unlike a rigid piece of paper which allows displacement coding of dots, the soft silicone is easily bent or compressed and requires coding by contrast or color. While contrast coding makes sense for grayscale printing on paper, the LensLeech is intended to be suitable for color prints and commodity cameras with RGB sensors, thus it can rely on color coding.

While a hexagonal arrangement of points offers the densest packing it is incompatible with a 2D-DeBruijn sequence. Hence, we computed a DeBruijn-like pattern with 7-point hexagons instead of 3×3 matrices using a brute-force approach. Each overlapping hexagonal sliding window in the pattern is unique in the given rotation (see fig. 3). An optimal pattern does contain only hexagons that are unique in all rotations which simplifies pattern matching during image processing, however, this requires a minimum of three colors at a suitable pattern size. Higher robustness to adverse lighting conditions and a less error-prone fabrication with only two different paints is the reason why a less-than-optimal two-color pattern is preferable.

Our hexagon patterns consist of 127 points and require 91 unique sliding windows. This is sufficient to cover the visible region of the silicone attachment even when placed on a wide-angle camera. While other sensors such as TacTip and GelSight Wedge use the same or similar number of points, only a subset of points is visible at a time for our application due to the magnification of the silicone lens. If a unique center hexagon is enforced during pattern generation up to 28 patterns can be discerned. This allows to create a set of multiple LensLeech widgets with unique patterns that can be mapped to different inputs or functions on the same device.

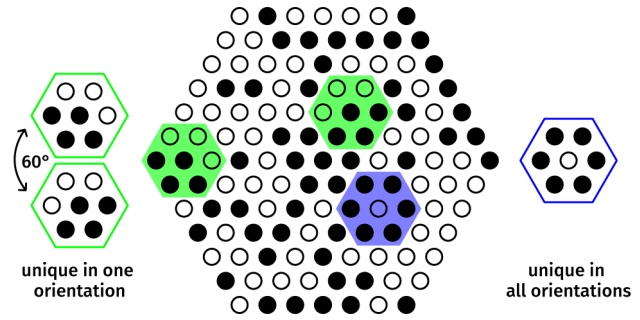

Figure 3: Each hexagonal sliding window appears only once. Some sliding windows are unique in all six orientations, some can be found in multiple locations when rotated.

Image Processing

The DeBruijn-like point pattern is color-coded in blue and green to offer a high contrast across the range of human skin tones (which can be expected to be visible in the background as touching fingers). Coincidentally, the fingertips have fewer variations due to smaller differences in the skin tones of palms overall. The detection and classification of the points is the first step of the image processing pipeline. Background removal is performed by thresholding in the HSV color space. The diffuse top surface of the silicone body improves this step considerably without blocking any ambient light. From these point candidates, colors are extracted and classified by thresholding the two classes in the hue component of the HSV colorspace using Otsu’s method [25]. This is computationally less expensive than other classification methods while being robust to errors in the white balance of the image data. These white balance errors are a frequent issue caused by tinted ambient light or overshooting of the camera’s built-in auto white balance algorithm when a fingertip is placed on the point pattern or removed.

For pattern matching each detected point is grouped with its 6 closest neighbors and all 6 rotation variants are checked against a lookup table. Correct rotation is assumed when the highest number of matches is found between neighboring sliding windows in the camera image and ground truth pattern. Given an optimal pattern, only one rotation would result in a match (in the absence of any errors), yet this computationally expensive step is necessary to limit the pattern to only two colors. This makes the pipeline’s processing speed highly dependent on the number of detected points. On a laptop computer (2.3 GHz 8-Core Intel i9) 34 frames per second are processed when 39 points are visible (30% of the pattern) and 21 FPS when 69 points (70%) are visible. Smartphone performance numbers are not reported since the Android implementation performs segmentation on-device but currently outsources the pattern-matching step of the pipeline to an external server.

The input gestures are derived directly from the matched point pattern (see fig. 4). A press on the top is recognized by detecting locally increased distances between neighboring points, pushing sideways by computing the centroid of all detected points, rotation by Kabsch’s algorithm [15], and squeeze by a global change of point distances along the squeeze axis. The gesture detection relies on

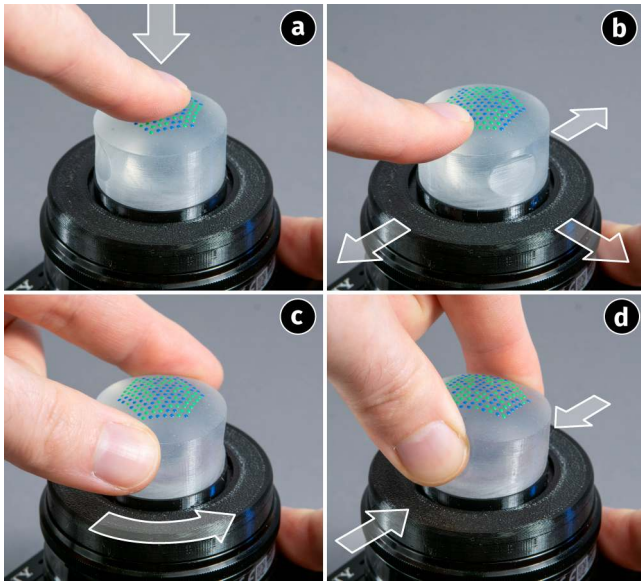

Figure 4: The four types of input: a) Pressing on the silicone body b) lateral pushing in any direction c) rotation on the optical axis d) squeezing the silicone.

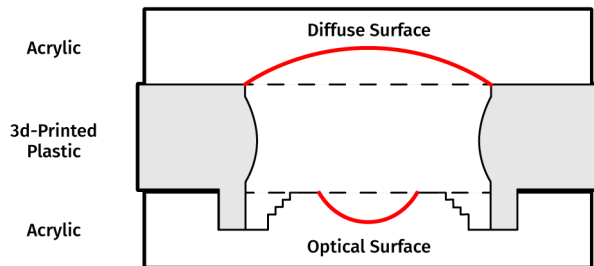

Figure 5: Cross section of the mold. The curved surfaces are ground and polished each with a precision steel ball of the required curvature. The optical surface is polished to a 2-micron finish and the diffuse surface to 40 microns. All three sections of the mold are aligned with metal dowel pins (not pictured). Liquid silicone is poured through a horizontal channel in the 3d-printed plastic part.

algorithm implementations in SciPy [37], while processing of image data is done using OpenCV.

Before discussing how these input types inform examples for real-world application, the fabrication process of both silicone body and color-coding pattern is described briefly.

4 FABRICATION

The clear silicone body is created by mixing, degassing, and pouring liquid silicone (Trollfactory Type 19) into a mold and letting it cure. The mold itself requires two precisely manufactured features. The lower cavity is an optical surface (sufficiently smooth to refract light for imaging applications) to create the spherical convex lens of 7.5mm radius for focusing. The curved top surface of 30mm

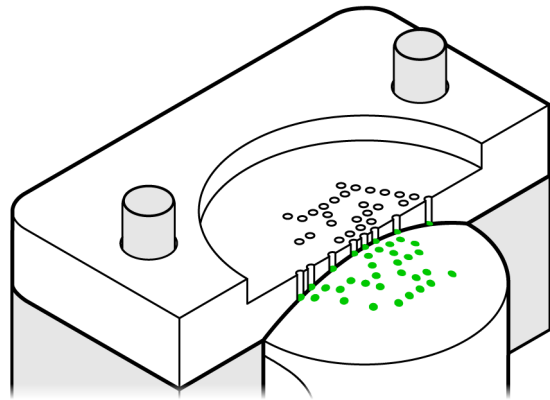

Figure 6: Cross section of the stenciling fixture. The silicone body is pressed upwards against the curved surface to create a seal. Once locked in place by clamps, the liquid pigmented silicone is poured into the recess at the top of the stencil and makes its way through the micro-drilled channels. When the stencil is lifted a small domed blob of partially-cured silicone paint remains on the surface. The stencil and fixture for the silicone body are aligned with metal dowel pins to ensure precise placement for each consecutive stencil and color.

radius diffuses light. Both surfaces are CNC-milled from acrylic before being ground and polished. For this, the spherical surface of the acrylic part is coated with lapping paste and pressed against a rotating steel ball of matching radius (widely available as high-precision replacement parts for large ball bearings). After polishing the acrylic plates are fastened to a 3d-printed center part to complete the mold (see fig. 5). Once cured and de-molded the point pattern is applied to the clear silicone body with two 3d-stencils milled from acrylic (one per color). The stencil is fabricated by drilling a duplicate of the mold top part with a circuit board drill (1.0mm) to create channels. The soft body is pressed into the matching cavity of the stencil from below and the pigmented silicone can be poured on the channels (see fig. 6) before removing the remaining air from the channels in a vacuum chamber. The stencil guarantees correct placement and uniform point size. Only silicone itself bonds reliably to cured silicone parts, thus uncured silicone mixed with color pigments is the most suitable paint. The main issues in this process are ensuring that the high-viscosity silicone reliably fills the channels and avoiding oversaturation of the silicone with pigments in a silicone oil solution, which may inhibit the curing process. A mixture (by weight) of Smooth-On’s Psycho Paint silicone with 15 percent dry UV-reactive pigment powder and 25 percent solvent (toluene) to lower the viscosity worked best. After 24 hours the pigmented silicone binds reliably to the optically-clear silicone body, creating a point pattern on the surface that is flexible and wear-resistant.

The choice of lens curvature during mold production is a trade-off. A mold for a lens with a stronger curvature is more demanding in fabrication but the shorter focal length allows to reduce the height of the silicone body. At the same time, it decreases the depth of field and the field of view, allowing to track a lower number of

points in the pattern. Additionally, interacting with the LensLeech deforms both top surface and lens. A strong press on the top will reduce the height of the body by several millimeters depending on the hardness of the silicone. If the height of the silicone body does not match the focal length the light will not exit the system collimated, resulting in a pattern that would be out of focus. In reality, this is rarely an issue since autofocus cameras can compensate for this, fixed-focus cameras often have a sufficient depth of field, and the image processing pipeline is robust to low levels of blurring.

A paraxial approximation of the focal length can be obtained using the lensmaker's equation. Only the refraction of the first surface is relevant for the LensLeech geometry, so a thin, plano-convex lens in air ($d = 0, R_2 = \infty$) can be assumed:

$$\frac{1}{f} = (n - 1) \left(\frac{1}{R_1} - \frac{1}{R_2} + \frac{(n - 1)d}{nR_1R_2} \right) = \frac{n}{R_1} - \frac{1}{R_1}$$

We have chosen a radius of $R_1 = 7.5\text{mm}$ for the lens surface and assume that Trollfactory Type 19 has a refractive index of $n = 1.41$, similar to other platinum-cure silicones. This would result in a total focal length of 18.29mm. To account for the deformation during interaction and the strong curvature of the lens we increase the height of the silicone body by a factor of 1.3 to 25mm. While the LensLeech should be able to touch the glass surface of the camera lens, the silicone lens surface in the center requires an air gap to refract light. Thus we extend the foot around the lens by 1.0mm to account for deformations (cross section can be seen in fig. 2). This provided the most reliable results during testing for high forces when pressing and squeezing while still keeping the point pattern well within the depth of field of most cameras when not deformed.

While fabrication is the primary challenge to making close-focus silicone lens attachments, a thorough description would go beyond the scope of this paper. Please refer to the companion repository¹ for detailed information about the fabrication process.

5 APPLICATION EXAMPLES

Tactile on-lens input can be used in a variety of scenarios for devices with cameras in many sizes. We present two application examples that show how on-lens interaction can be utilized to make input on both large and small cameras more convenient and transfer well-established tangible interaction techniques to smartphones.

Interactive Lens Caps for Digital Cameras

Small action cameras offer a very limited number of buttons, a tiny display (if any), and only optionally, a touch interface on this display. While there are techniques to facilitate touch input on very small displays [2], it may be cumbersome. Adjusting settings is often performed via a companion app on a smartphone which is paired with the wearable camera. However, there are scenarios in which the phone is unavailable and direct interaction with the device itself may be favorable. These can be casual, everyday situations like wearing gloves or very specific use cases such as interacting with a camera enclosed in a waterproof housing while swimming or diving. By adopting a lens cap or protective storage case that integrates a LensLeech (see fig. 7), we can add tangible controls such

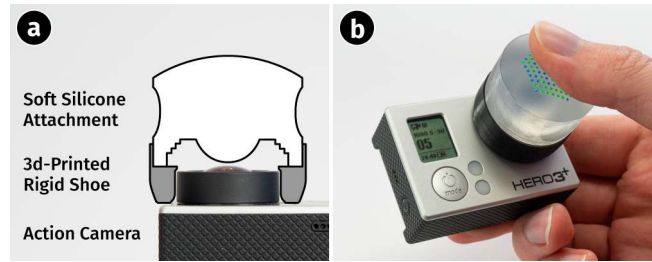

Figure 7: a) Cross section: the silicone attachment can be extended with a 3d-printed shoe matched to the specific device so it slides over the protruding wide-angle lens of an action camera. b) The LensLeech could be used as a rotating knob, press to confirm, squeeze to cancel.

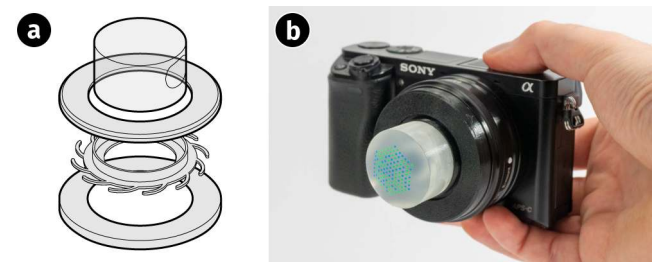

Figure 8: a) The silicone attachment is placed in a 3d-printed lens cap with a spring-loaded mechanism to allow lateral movement and rotation. b) The lens cap on an interchangeable-lens camera.

as a rotation knob or a d-pad, and extend the number of buttons on the device for easier navigation through nested menus. However, note that in the case of underwater usage when the LensLeech is pressed against a waterproof housing, a different silicone lens curvature will be required due to the refractive index of water.

While action cameras with 2-button interfaces require the user to arduously traverse a menu by cycling through a list or tree of menu items and confirming or canceling an operation, a LensLeech can be used to simulate other well-known input physical devices. When used similarly to a rotary knob, the widget on the camera can be rotated to quickly traverse a list, confirm an action by pressing on the soft silicone, or cancel it by squeezing the silicone body.

This concept extends to larger cameras as well. Many digital consumer cameras are infamous for convoluted menus and poor usability in general. Browsing recorded videos and photos, changing settings in nested menus, and cumbersome tasks such as entering credentials to set up wireless connections require prolonged attention and interaction while the sensor itself is not in use during these tasks. By integrating a silicone attachment into a lens cap we can leverage the unused hardware without interfering with the primary use case of the camera. Pressing the LensLeech sideways can be used to select menu items or control a cursor on the back of the device for the most demanding tasks like text input on a virtual keyboard (see fig. 8). While the soft silicone can touch lens coatings without damaging them, the lens cap in this case prevents

¹<https://github.com/volzotan/LensLeech>

direct contact and may provide reassurance to the user for these very expensive lenses.

Hybrid Viewfinders for Smartphones

While the LensLeech provides optical input to camera-based devices, it can be combined with other components that offer optical output as well. This allows to create complex passive optical add-ons to existing devices. The hybrid viewfinder slides over the top section of a smartphone covering the front lens and a portion of the display. By adding a beamsplitter prism to a camera viewfinder, a section of the covered display can be reflected into the viewfinder's optical path (see fig. 9a) to create a hybrid optical/electronic viewfinder for smartphone photography. By integrating the LensLeech into the viewfinder attachment, the front camera can be used for input while the rear camera takes images and optionally provides data for the viewfinder overlay (see fig. 9c). Rotating the LensLeech changes the data overlay and pressing it triggers image capture. This allows optical input and output with no hardware modifications, transforming a smartphone into a modern rangefinder-style camera.

6 EVALUATION & LIMITATIONS

When tested with artificially generated images (rendered images of the deformation point pattern with a pinhole aperture instead of a lens for focusing) the rotational error is negligible at an average of 0.03 degrees. More relevant and considerably more challenging is the real-world performance under low-light conditions and ambient light with color casts. As an evaluation setup, three cameras with an attached LensLeech (Pixel 3a smartphone, Sony A6000 + Sony 20mm 2.8 digital still camera, Raspberry Pi V1 embedded camera) were placed in complete darkness facing a display showing a subset (201 images, three per category) of the MIT indoor scene recognition dataset [28]. These were artificially darkened and brightened to simulate a low-light environment (resulting in a total of 1206 images). The illuminance of each scene was measured at the surface of the LensLeech with a TSL2591 ambient light sensor. Detection performance depends on the combination of sensor, lens, and environment, but in general, it can be observed that above 150 lux reliable operation can be expected (see fig.10). Indoor lighting conditions usually exceed 150 lux while 300-500 lux are recommended for office work [13].

The main limitation when using any optical attachment on lenses is the entrance pupil diameter and the pupil's distance from the first surface of the lens. The entrance pupil is a virtual opening within the lens barrel through which all entering light rays pass. Size and position within lenses can vary across lens designs, even when an image of a distant object taken with different lenses would look identical (see fig. 11). The silicone attachment (in the size as presented) works well on small and medium-sized lenses but requires a different geometry on very large lenses such as professional photography or videography lenses with large front elements and entrance pupils for better low-light performance. These very large lenses would require an equally-sized LensLeech. As a rule of thumb: if the image of the aperture seen through the front element of the lens is considerably larger than the silicone lens (12mm in diameter) the number of visible points is strongly reduced. In general, a lower bound of 19 points is required to reliably recognize input gestures

through the soft widget. Additional limiting factors on the optical system are the field of view of the lens and the curvature of the first glass element of the lens. A camera with a narrow field of view will reduce the number of visible points, similar to a large entrance pupil. This makes the presented concept more suitable for medium to wide-angle systems such as webcams, smart home devices, smartphones, and wearable cameras. Lenses with very small entrance pupils offer the additional benefit of an increased distance between first lens element and silicone body, for example, a smartphone lens can reliably detect the LensLeech pattern at a distance of up to 10 millimeters above the lens. If the LensLeech is used with hard attachments (such as the lens cap) it does not sit directly on the glass and a strong lens curvature is not an issue.

7 DISCUSSION

Compared to other on-lens interaction concepts such as *CamTrack-Point* [51] and *LensGestures* [50]) that process unfocused light, the LensLeech is less limited in the amount of information it provides but it requires ambient light as well. While the LensLeech performs well in most situations, LEDs (such as smartphone flashlights and autofocus-assist lights of still cameras) or screens of devices can be used to provide additional artificial illumination. This can be seen in the hybrid viewfinder: a section of the covered display illuminates the point pattern from below. Depending on the device and application scenario this might not be a viable option. For usage within a predefined space, near-ultraviolet flood lights can be installed to brighten the UV-reactive pigments in the point pattern (see fig. 12) with little interference to the brightness of the environment.

In general, an attachment solely made from silicone is simple, robust, and—to an extent—expendable. Material cost per piece is about 2 USD/EUR when fabricated in small quantities. This makes the LensLeech comparable to other inexpensive attachments for mobile devices that extend I/O capabilities, such as Google Cardboard or Nintendo Labo. Similar to the limited lifetime of corrugated cardboard, a LensLeech and its point pattern may eventually suffer from wear and tear after extended usage.

A possible negative perception of letting an object touch the front element of the lens is not an issue when used on smartphone lenses. The application examples show that in other scenarios it makes sense to use device-dependent additions such as a rigid shoe on protruding lens barrels for action cameras or lens caps on interchangeable-lens cameras.

8 FUTURE WORK

A LensLeech is uniformly made from a single silicone formula with consistent Shore hardness throughout the whole body. By making use of a two-stage mold, the lower part of the body containing the lens could be molded separately with a harder type of clear silicone, resulting in a lower deformation of the lens when compressed. Also by integrating air-filled cavities and compliant elements in multi-stage molds, tactile feedback can be provided, resulting in a sensation when a certain amount of force is applied.

The limitation of large entrance pupil sizes can be circumvented by replacing the single silicone lens with a grid of smaller lenses. This requires a different fabrication technique for the mold and a point pattern that is aligned with camera lens angle and microlens



Figure 9: a) Cross section of the hybrid viewfinder. The beamsplitter overlays the light emitted by a section of the smartphone screen (blue) over the viewfinder image of the world (yellow), while the silicone attachment rests on the front camera (red). b) The finder can be slid over the top section of the smartphone. The silicone attachment provides rich tangible input to control settings and take a photo without visual confirmation as a touchscreen would require. c) View through the finder showing an overlay of the selection menu and a digital spirit level.

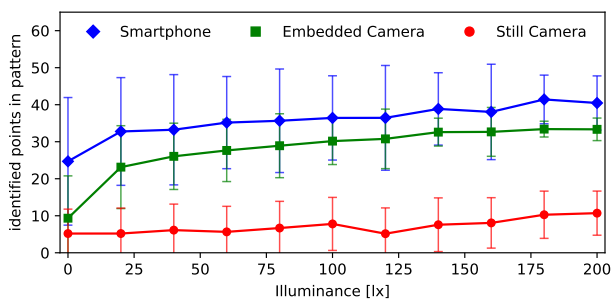

Figure 10: Mean number of identified points in relation to ambient illumination strength. Error bars specify standard deviation. Monochromatic or environmental light with a strong color tint will result in an undetectable point pattern regardless of illumination strength, this is the main cause for outliers in the plot. Note: the maximum number of points visible to the camera varies across devices depending on pupil size and field of view.

position. This limits the silicone attachment compatibility to only a single lens, yet this may not be an issue for applications such as model-specific lens caps.

While only a single type of LensLeech is presented, the concept is versatile. With additional illumination and a geometry that introduces an angle between widget surface and camera lens, ridges and valleys of fingerprints can be detected, making it possible to differentiate not only between widgets but between the fingers of a user as well. By replacing the single large lens in the silicone body with an array of smaller lenses a wider area on the top surface of the widget can be covered. This would allow to reliably detect the position of a touching fingertip, at the cost of considerably more complex manufacturing of molds. In the near future, the emergence

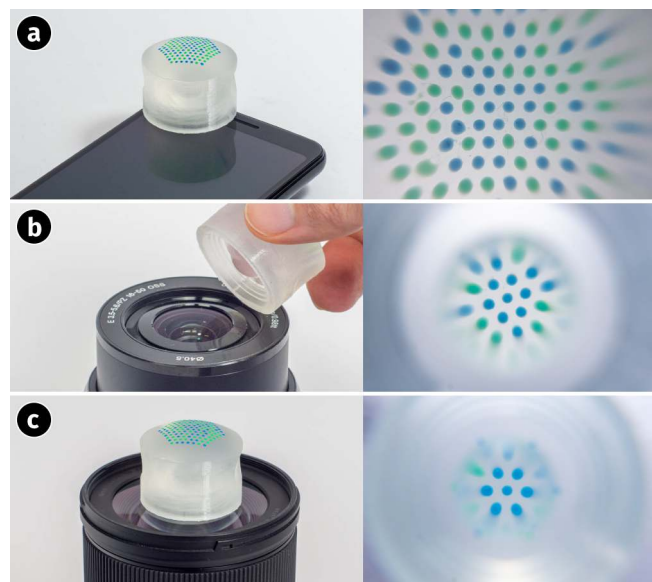

Figure 11: Three lenses with an identical field of view of 84° but increasing entrance pupil diameters: a) Google Pixel 3a front camera b) Sony SEL-P1650 lens (16mm focal length) c) Sigma 16mm 1.4 DC DN (16mm focal length). For all three images, the LensLeech is resting directly on the front element of the camera lens.

of cameras under displays in smartphones would allow the use of silicone attachments as tangible input and output devices in tabletop-like scenarios. The display can be used both for illuminating the LensLeech to sense in dark spaces as well as to display output in or on the body itself by refracting and redirecting the light.

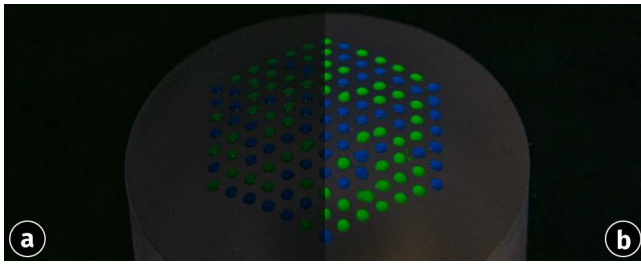

Figure 12: Near-UV flood illumination can considerably increase the brightness and contrast of the UV-reactive pigments in the point pattern while it only marginally brightens the environment. a) No ultraviolet illumination b) Single 365nm-wavelength light source.

9 CONCLUSION

We presented the LensLeech, a soft silicone attachment that allows to sense pushing, pressing, rotating, and squeezing when placed directly on or above lenses of arbitrary cameras. This makes it possible to add tangible input methods to a wide range of existing and new devices, especially small action or lifelogging cameras and smartphones. We have shown application examples ranging from small, body-worn devices to lens caps for large cameras and complex smartphone attachments. While the attachments are limited in their compatibility mainly by lens geometry, the low-light performance allows them to be used with only ambient illumination without any need for hardware modifications on a wide range of existing devices. This simple and inexpensive approach opens up an interaction space on lenses for rich input that was previously inaccessible with a range of further applications in the (soft) robotics domain.

REPRODUCTION NOTE

The example applications, source code, CAD models of molds and fixtures, a detailed description of the fabrication process, and data/scripts for generating plots are available publicly: <https://github.com/volzotan/LensLeech>

ACKNOWLEDGMENTS

This work was funded by the Deutsche Forschungsgemeinschaft (DFG, German Research Foundation) through project EC437/1-1.

REFERENCES

- [1] Alexander C. Abad and Anuradha Ranasinghe. 2020. Visuotactile Sensors With Emphasis on GelSight Sensor: A Review. *IEEE Sensors Journal* 20, 14 (July 2020), 7628–7638. <https://doi.org/10.1109/JSEN.2020.2979662>
- [2] Patrick Baudisch and Gerry Chu. 2009. Back-of-Device Interaction Allows Creating Very Small Touch Devices. In *Proceedings of the SIGCHI Conference on Human Factors in Computing Systems (CHI '09)*. Association for Computing Machinery, New York, NY, USA, 1923–1932. <https://doi.org/10.1145/1518701.1518995>
- [3] Andrea Bianchi and Ian Oakley. 2015. MagnID: Tracking Multiple Magnetic Tokens. In *Proceedings of the Ninth International Conference on Tangible, Embedded, and Embodied Interaction (TEI '15)*. Association for Computing Machinery, New York, NY, USA, 61–68. <https://doi.org/10.1145/2677199.2680582>
- [4] William Buxton, Ralph Hill, and Peter Rowley. 1985. Issues and Techniques in Touch-Sensitive Tablet Input. In *Proceedings of the 12th Annual Conference on Computer Graphics and Interactive Techniques (SIGGRAPH '85)*. Association for Computing Machinery, New York, NY, USA, 215–224. <https://doi.org/10.1145/325334.325239>
- [5] Siyuan Dong, Wenzhen Yuan, and Edward H. Adelson. 2017. Improved GelSight Tactile Sensor for Measuring Geometry and Slip. In *2017 IEEE/RSJ International Conference on Intelligent Robots and Systems (IROS)*. 137–144. <https://doi.org/10.1109/IROS.2017.8202149>
- [6] Elliott Donlon, Siyuan Dong, Melody Liu, Jianhua Li, Edward Adelson, and Alberto Rodriguez. 2018. GelSlim: A High-Resolution, Compact, Robust, and Calibrated Tactile-sensing Finger. In *2018 IEEE/RSJ International Conference on Intelligent Robots and Systems (IROS)*. 1927–1934. <https://doi.org/10.1109/IROS.2018.8593661>
- [7] Sean Follmer, Micah Johnson, Edward Adelson, and Hiroshi Ishii. 2011. deForm: An Interactive Malleable Surface for Capturing 2.5D Arbitrary Objects, Tools and Touch. In *Proceedings of the 24th Annual ACM Symposium on User Interface Software and Technology (UIST '11)*. Association for Computing Machinery, New York, NY, USA, 527–536. <https://doi.org/10.1145/2047196.2047265>
- [8] Florian Heller, Simon Voelker, Chat Wacharamanatham, and Jan Borchers. 2015. Transporters: Vision & Touch Transitive Widgets for Capacitive Screens. In *Proceedings of the 33rd Annual ACM Conference Extended Abstracts on Human Factors in Computing Systems (CHI EA '15)*. Association for Computing Machinery, New York, NY, USA, 1603–1608. <https://doi.org/10.1145/2702613.2732707>
- [9] Fabian Hennecke, Franz Berwein, and Andreas Butz. 2011. Optical Pressure Sensing for Tangible User Interfaces. In *Proceedings of the ACM International Conference on Interactive Tabletops and Surfaces (ITS '11)*. Association for Computing Machinery, New York, NY, USA, 45–48. <https://doi.org/10.1145/2076354.2076362>
- [10] H. Hiraishi, N. Suzuki, M. Kaneko, and Kazuo Tanie. 1988. An Object Profile Detection by a High Resolution Tactile Sensor Using an Optical Conductive Plate. In *Proceedings, 14 Annual Conference of Industrial Electronics Society*, Vol. 4. 982–987. <https://doi.org/10.1109/IECON.1988.666278>
- [11] Sungjae Hwang, Andrea Bianchi, Myungwook Ahn, and Kwangyun Wohn. 2013. MagPen: Magnetically Driven Pen Interactions on and around Conventional Smartphones. In *Proceedings of the 15th International Conference on Human-Computer Interaction with Mobile Devices and Services (MobileHCI '13)*. Association for Computing Machinery, New York, NY, USA, 412–415. <https://doi.org/10.1145/2493190.2493194>
- [12] Kaori Ikematsu, Masaaki Fukumoto, and Itiro Sii. 2019. Ohmic-Sticker: Force-to-Motion Type Input Device That Extends Capacitive Touch Surface. In *Proceedings of the 32nd Annual ACM Symposium on User Interface Software and Technology (New Orleans, LA, USA) (UIST '19)*. Association for Computing Machinery, New York, NY, USA, 1021–1030. <https://doi.org/10.1145/3332165.3347903>
- [13] ISO 8995-1:2002 2002. *Lighting of work places – Indoor: Part 1*. Standard. International Organization for Standardization, Geneva, CH.
- [14] Micah K. Johnson and Edward H. Adelson. 2009. Retrographic Sensing for the Measurement of Surface Texture and Shape. In *2009 IEEE Conference on Computer Vision and Pattern Recognition*. 1070–1077. <https://doi.org/10.1109/CVPR.2009.5206534>
- [15] Wolfgang Kabsch. 1976. A Solution for the Best Rotation to Relate Two Sets of Vectors. *Acta Crystallographica Section A: Crystal Physics, Diffraction, Theoretical and General Crystallography* 32, 5 (Sept. 1976), 922–923. <https://doi.org/10.1107/S0567739476001873>
- [16] Kazuto Kamiyama, Hiroyuki Kajimoto, Naoki Kawakami, and Susumu Tachi. 2004. Evaluation of a Vision-Based Tactile Sensor. In *IEEE International Conference on Robotics and Automation, 2004. Proceedings. ICRA '04. 2004, Vol. 2*. 1542–1547 Vol.2. <https://doi.org/10.1109/ROBOT.2004.1308043>
- [17] Kunihiro Kato, Kaori Ikematsu, and Yoshihiro Kawahara. 2020. CAPath: 3D-Printed Interfaces with Conductive Points in Grid Layout to Extend Capacitive Touch Inputs. *Proceedings of the ACM on Human-Computer Interaction* 4, ISS (Nov. 2020), 193:1–193:17. <https://doi.org/10.1145/3427321>
- [18] Takuya Kitade and Wataru Yamada. 2019. Prismodule: Modular UI for Smartphones Using Internal Reflection. In *The Adjunct Publication of the 32nd Annual ACM Symposium on User Interface Software and Technology (UIST '19)*. Association for Computing Machinery, New York, NY, USA, 119–121. <https://doi.org/10.1145/3332167.3356892>
- [19] Mike Lambeta, Po-Wei Chou, Stephen Tian, Brian Yang, Benjamin Maloon, Victoria Rose Most, Dave Stroud, Raymond Santos, Ahmad Byagowi, Gregg Kammerer, Dinesh Jayaraman, and Roberto Calandra. 2020. DIGIT: A Novel Design for a Low-Cost Compact High-Resolution Tactile Sensor With Application to In-Hand Manipulation. *IEEE Robotics and Automation Letters* 5, 3 (July 2020), 3838–3845. <https://doi.org/10.1109/LRA.2020.2977257>
- [20] Gierad Laput, Eric Brockmeyer, Scott E. Hudson, and Chris Harrison. 2015. Acousturments: Passive, Acoustically-Driven, Interactive Controls for Handheld Devices. In *Proceedings of the 33rd Annual ACM Conference on Human Factors in Computing Systems (CHI '15)*. Association for Computing Machinery, New York, NY, USA, 2161–2170. <https://doi.org/10.1145/2702123.2702414>
- [21] Rong-Hao Liang, Liwei Chan, Hung-Yu Tseng, Han-Chih Kuo, Da-Yuan Huang, De-Nian Yang, and Bing-Yu Chen. 2014. GaussBricks: Magnetic Building Blocks for Constructive Tangible Interactions on Portable Displays. In *Proceedings of the SIGCHI Conference on Human Factors in Computing Systems (CHI '14)*. Association for Computing Machinery, New York, NY, USA, 3153–3162. <https://doi.org/10.1145/2556288.2557105>

- [22] Nobutaka Matsushima, Wataru Yamada, and Hiroyuki Manabe. 2017. Attaching Objects to Smartphones Back Side for a Modular Interface. In *Adjunct Publication of the 30th Annual ACM Symposium on User Interface Software and Technology (UIST '17)*. Association for Computing Machinery, New York, NY, USA, 51–52. <https://doi.org/10.1145/3131785.3131810>
- [23] Ankit Mohan, Grace Woo, Shinsaku Hiura, Quinn Smithwick, and Ramesh Raskar. 2009. Bokode: Imperceptible Visual Tags for Camera Based Interaction from a Distance. In *ACM SIGGRAPH 2009 Papers (SIGGRAPH '09)*. Association for Computing Machinery, New York, NY, USA, 1–8. <https://doi.org/10.1145/1576246.1531404>
- [24] Goro Obinata, Ashish Dutta, Norinao Watanabe, and Nobuhiko Moriyam. 2007. Vision Based Tactile Sensor Using Transparent Elastic Fingertip for Dexterous Handling. In *Mobile Robots: Perception & Navigation*, Sascha Kolski (Ed.). Pro Literatur Verlag, Germany / ARS, Austria. <https://doi.org/10.5772/4771>
- [25] Nobuyuki Otsu. 1979. A Threshold Selection Method from Gray-Level Histograms. *IEEE Transactions on Systems, Man, and Cybernetics* 9, 1 (Jan. 1979), 62–66. <https://doi.org/10.1109/TSMC.1979.4310076>
- [26] Mats Petter Petterson and Tomas Edso. 2003. Patent US-6548768-B1: Determination of a Position Code.
- [27] Parinya Punpongsonan, Daisuke Iwai, and Kosuke Sato. 2013. DeforMe: Projection-Based Visualization of Deformable Surfaces Using Invisible Textures. In *SIGGRAPH Asia 2013 Emerging Technologies (SA '13)*. Association for Computing Machinery, New York, NY, USA, 1–3. <https://doi.org/10.1145/2542284.2542292>
- [28] Ariadna Quattori and Antonio Torralba. 2009. Recognizing Indoor Scenes. In *2009 IEEE Conference on Computer Vision and Pattern Recognition*. 413–420. <https://doi.org/10.1109/CVPR.2009.5206537>
- [29] Toshiaki Sato, Haruko Mamiya, Hideki Koike, and Kentaro Fukuchi. 2009. PhotoelasticTouch: Transparent Rubbery Tangible Interface Using an LCD and Photoelasticity. In *Proceedings of the 22nd Annual ACM Symposium on User Interface Software and Technology (UIST '09)*. Association for Computing Machinery, New York, NY, USA, 43–50. <https://doi.org/10.1145/1622176.1622185>
- [30] Valkyrie Savage, Colin Chang, and Björn Hartmann. 2013. Sauron: Embedded Single-Camera Sensing of Printed Physical User Interfaces. In *Proceedings of the 26th Annual ACM Symposium on User Interface Software and Technology (UIST '13)*. Association for Computing Machinery, New York, NY, USA, 447–456. <https://doi.org/10.1145/2501988.2501992>
- [31] Martin Schmitz, Jürgen Steimle, Jochen Huber, Niloofar Dezfuli, and Max Mühlhäuser. 2017. Flexibles: Deformation-Aware 3D-Printed Tangibles for Capacitive Touchscreens. In *Proceedings of the 2017 CHI Conference on Human Factors in Computing Systems (CHI '17)*. Association for Computing Machinery, New York, NY, USA, 1001–1014. <https://doi.org/10.1145/3025453.3025663>
- [32] Dennis Schüsselbauer, Andreas Schmid, and Raphael Wimmer. 2021. Dothraki: Tracking Tangibles Atop Tabletops Through De-Brujin Tori. In *Proceedings of the Fifteenth International Conference on Tangible, Embedded, and Embodied Interaction (TEI '21)*. Association for Computing Machinery, New York, NY, USA, 1–10. <https://doi.org/10.1145/3430524.3440656>
- [33] Carmelo Sferrazza and Raffaello D'Andrea. 2019. Design, Motivation and Evaluation of a Full-Resolution Optical Tactile Sensor. *Sensors* 19, 4 (Jan. 2019), 928. <https://doi.org/10.3390/s19040928>
- [34] Kazuhiro Shimonomura. 2019. Tactile Image Sensors Employing Camera: A Review. *Sensors* 19, 18 (Jan. 2019), 3933. <https://doi.org/10.3390/s19183933>
- [35] Katie A. Siek, Yvonne Rogers, and Kay H. Connelly. 2005. Fat Finger Worries: How Older and Younger Users Physically Interact with PDAs. In *Human-Computer Interaction - INTERACT 2005 (Lecture Notes in Computer Science)*, Maria Francesca Costabile and Fabio Paternò (Eds.). Springer, Berlin, Heidelberg, 267–280. https://doi.org/10.1007/11555261_24
- [36] Ian Taylor, Siyuan Dong, and Alberto Rodriguez. 2021. GelSlim3.0: High-Resolution Measurement of Shape, Force and Slip in a Compact Tactile-Sensing Finger. *arXiv:2103.12269 [cs]* (March 2021). [arXiv:2103.12269 \[cs\]](https://arxiv.org/abs/2103.12269)
- [37] Pauli Virtanen, Ralf Commers, Travis E. Oliphant, Matt Haberland, Tyler Reddy, David Cournapeau, Evgeni Burovski, Pearu Peterson, Warren Weckesser, Jonathan Bright, Stéfan J. van der Walt, Matthew Brett, Joshua Wilson, K. Jarrod Millman, Nikolay Mayorov, Andrew R. J. Nelson, Eric Jones, Robert Kern, Eric Larson, C J Carey, İlhan Polat, Yu Feng, Eric W. Moore, Jake VanderPlas, Denis Laxalde, Josef Perktold, Robert Cimrman, Ian Henriksen, E. A. Quintero, Charles R. Harris, Anne M. Archibald, Antônio H. Ribeiro, Fabian Pedregosa, Paul van Mulbregt, and SciPy 1.0 Contributors. 2020. SciPy 1.0: Fundamental Algorithms for Scientific Computing in Python. *Nature Methods* 17 (2020), 261–272. <https://doi.org/10.1038/s41592-019-0686-2>
- [38] Aaron Visschedijk, Hyunyoung Kim, Carlos Tejada, and Daniel Ashbrook. 2022. ClipWidgets: 3D-printed Modular Tangible UI Extensions for Smartphones. In *Sixteenth International Conference on Tangible, Embedded, and Embodied Interaction (TEI '22)*. Association for Computing Machinery, New York, NY, USA, 1–11. <https://doi.org/10.1145/3490149.3501314>
- [39] Shaoxiong Wang, Yu She, Brandon Romero, and Edward Adelson. 2021. GelSight Wedge: Measuring High-Resolution 3D Contact Geometry with a Compact Robot Finger. In *2021 IEEE International Conference on Robotics and Automation (ICRA)*, 6468–6475. <https://doi.org/10.1109/ICRA48506.2021.9560783>
- [40] Benjamin Ward-Cherrier, Nicholas Pestell, Luke Cramporn, Benjamin Winstone, Maria Elena Giannaccini, Jonathan Rossiter, and Nathan F. Lepora. 2018. The TacTip Family: Soft Optical Tactile Sensors with 3D-Printed Biomimetic Morphologies. *Soft Robotics* 5, 2 (April 2018), 216–227. <https://doi.org/10.1089/soro.2017.0052>
- [41] Chihiro Watanabe, Alvaro Cassinelli, Yoshihiro Watanabe, and Masatoshi Ishikawa. 2014. Generic Method for Crafting Deformable Interfaces to Physically Augment Smartphones. In *CHI '14 Extended Abstracts on Human Factors in Computing Systems (CHI EA '14)*. Association for Computing Machinery, New York, NY, USA, 1309–1314. <https://doi.org/10.1145/2559206.2581307>
- [42] Martin Weigel and Jürgen Steimle. 2017. DeformWear: Deformation Input on Tiny Wearable Devices. *Proceedings of the ACM on Interactive, Mobile, Wearable and Ubiquitous Technologies* 1, 2 (June 2017), 28:1–28:23. <https://doi.org/10.1145/3090093>
- [43] Malte Weiss, Julie Wagner, Yvonne Jansen, Roger Jennings, Ramsin Khoshabeh, James D. Hollan, and Jan Borchers. 2009. SLAP Widgets: Bridging the Gap between Virtual and Physical Controls on Tabletops. In *Proceedings of the SIGCHI Conference on Human Factors in Computing Systems (CHI '09)*. Association for Computing Machinery, New York, NY, USA, 481–490. <https://doi.org/10.1145/1518701.1518779>
- [44] Raphael Wimmer. 2010. FlyEye: Grasp-Sensitive Surfaces Using Optical Fiber. In *Proceedings of the Fourth International Conference on Tangible, Embedded, and Embodied Interaction (TEI '10)*. Association for Computing Machinery, New York, NY, USA, 245–248. <https://doi.org/10.1145/1709886.1709935>
- [45] Benjamin Winstone, Gareth Griffiths, Chris Melhuish, Tony Pipe, and Jonathan Rossiter. 2012. TACTIP – Tactile Fingertip Device, Challenges in Reduction of Size to Ready for Robot Hand Integration. In *2012 IEEE International Conference on Robotics and Biomimetics (ROBIO)*. 160–166. <https://doi.org/10.1109/ROBIO.2012.6490960>
- [46] Jacob O. Wobbrock, Brad A. Myers, and Htet Htet Aung. 2008. The Performance of Hand Postures in Front- and Back-of-Device Interaction for Mobile Computing. *International Journal of Human-Computer Studies* 66, 12 (Dec. 2008), 857–875. <https://doi.org/10.1016/j.ijhcs.2008.03.004>
- [47] Pui Chung Wong, Hongbo Fu, and Kening Zhu. 2016. Back-Mirror: Back-of-Device One-Handed Interaction on Smartphones. In *SIGGRAPH ASIA 2016 Mobile Graphics and Interactive Applications (SA '16)*. Association for Computing Machinery, New York, NY, USA, 1–2. <https://doi.org/10.1145/2999508.2999512>
- [48] Chang Xiao, Karl Bayer, Changxi Zheng, and Shree K. Nayar. 2019. Widgets: Modular Mechanical Widgets for Mobile Devices. *ACM Transactions on Graphics* 38, 4 (July 2019), 100:1–100:12. <https://doi.org/10.1145/3306346.3322943>
- [49] Chang Xiao, Karl Bayer, Changxi Zheng, and Shree K. Nayar. 2021. BackTrack: 2D Back-of-device Interaction Through Front Touchscreen. In *Proceedings of the 2021 CHI Conference on Human Factors in Computing Systems (CHI '21)*. Association for Computing Machinery, New York, NY, USA, 1–8. <https://doi.org/10.1145/3411764.3445374>
- [50] Xiang Xiao, Teng Han, and Jingtao Wang. 2013. LensGesture: Augmenting Mobile Interactions with Back-of-Device Finger Gestures. In *Proceedings of the 15th ACM on International Conference on Multimodal Interaction (ICMI '13)*. Association for Computing Machinery, New York, NY, USA, 287–294. <https://doi.org/10.1145/2522848.2522850>
- [51] Wataru Yamada, Hiroyuki Manabe, and Daizo Ikeda. 2018. CamTrackPoint: Camera-Based Pointing Stick Using Transmitted Light through Finger. In *Proceedings of the 31st Annual ACM Symposium on User Interface Software and Technology (UIST '18)*. Association for Computing Machinery, New York, NY, USA, 313–320. <https://doi.org/10.1145/3242587.3242641>
- [52] Akihiko Yamaguchi and Christopher G. Atkeson. 2017. Implementing Tactile Behaviors Using FingerVision. In *2017 IEEE-RAS 17th International Conference on Humanoid Robotics (Humanoids)*. 241–248. <https://doi.org/10.1109/HUMANOIDS.2017.8246881>
- [53] Xing-Dong Yang, Khalad Hasan, Neil Bruce, and Pourang Irani. 2013. Surround-See: Enabling Peripheral Vision on Smartphones during Active Use. In *Proceedings of the 26th Annual ACM Symposium on User Interface Software and Technology (UIST '13)*. Association for Computing Machinery, New York, NY, USA, 291–300. <https://doi.org/10.1145/2501988.2502049>
- [54] Chun Yu, Xiaoying Wei, Shubb Vachher, Yue Qin, Chen Liang, Yueting Weng, Yizheng Gu, and Yuanchun Shi. 2019. HandSee: Enabling Full Hand Interaction on Smartphone with Front Camera-based Stereo Vision. In *Proceedings of the 2019 CHI Conference on Human Factors in Computing Systems (CHI '19)*. Association for Computing Machinery, New York, NY, USA, 1–13. <https://doi.org/10.1145/3290605.3300935>
- [55] Neng-Hao Yu, Sung-Sheng Tsai, I-Chun Hsiao, Dian-Je Tsai, Meng-Han Lee, Mike Y. Chen, and Yi-Ping Hung. 2011. Clip-on Gadgets: Expanding Multi-Touch Interaction Area with Unpowered Tactile Controls. In *Proceedings of the 24th Annual ACM Symposium on User Interface Software and Technology (UIST '11)*. Association for Computing Machinery, New York, NY, USA, 367–372. <https://doi.org/10.1145/2047196.2047243>